



## ALPHA 342 S2

AUTOMATIC BAR FEEDING SYSTEM FOR  
FIXED AND SLIDING HEADSTOCK LATHES

Diameter range: 3–42 mm

SIMPLE, RELIABLE, AFFORDABLE

The Alpha 342 S2 has been designed for maximum productivity and return over investment in the sliding headstock range, for long bars from 3 to 42 mm.



YOUR ONE-STOP-SHOP  
FOR MACHINE-TOOL PERIPHERALS



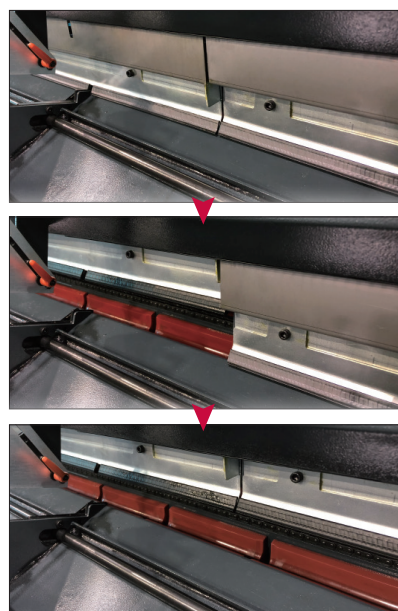

### OPTIMUM GUIDING

Despite its very compact footprint in its category, the new and patented solid steel structure with an increased focus to the front of the bar feeder combined with the polyurethane guiding elements dampens vibrations to ensure optimum performance up to 42 mm diameter range.

The uniquely designed and patented guiding system with multiple sectional guiding channel covers ensures ideal guiding system of bar stocks in rotation at high RPM (rotation per minute) during the whole machining process. As the first sectional channel cover will open, the others will remain safely closed, guaranteeing mechanical locking and maximum hydrodynamic effect, leading to the highest guiding performance.



The upgraded front rest with universal V-shaped guiding elements adapts to any round bar diameter, dampening any residual vibration and noise within the whole diameter range. Hexagonal and profiled bars will greatly benefit from the optional O-shaped guiding elements to reach the optimal performance.



### FAST AND EASY DIAMETER CHANGEOVER

Thanks to its simple design, a changeover within the same guiding elements takes less than a minute: replace the pusher collet by removing its quick-change pin, adjust the centrally controlled bar selection system to the new bar diameter on the auxiliary reference scale, and enter the parameters into the touchscreen HMI.

The innovative guiding elements allow a very simple full change-over: their symmetrical shape and tool-free positioning prevent any mistakes, bringing the barfeed into production safely and quickly.

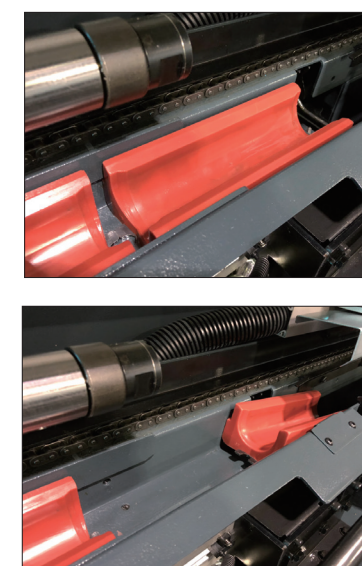

### SIMPLIFIED ERGONOMICS AND FULL EQUIPMENT

The user-friendly HMI with colourful touch screen, clear pictures and easy operation, provides all the information in the current context of usage: full-text alarm messages, images for troubleshooting and setup guides.



To facilitate the maintenance on the spindle, the Alpha 342 S2 is equipped with a longitudinal displacement that allows the upper part of the barfeed to move back, all while keeping the accurate alignment necessary to reach high guiding performance.

For sliding headstocks working with and without guidebush, an optional 2-position retraction with integrated safety allows the closest distance to the spindle, another cornerstone for reaching maximum performance.

## YOUR ONE-STOP-SHOP FOR MACHINE-TOOL PERIPHERALS

LNS provides a full range of bar feeders, chip conveyors, coolant management systems and air filtration systems which is second to none on the market. We are known in the industry for the solid expertise we have gained over several decades in an exceptionally wide range of applications, our excellent customer service and technical support. This support is ensured by highly qualified technicians who are available at key locations throughout Europe.

## TECHNICAL SPECIFICATIONS

Capacity	Alpha 342 S2
Diameter	3–42 mm (40 without bar preparation)
Bar length	3300 mm / 4400 mm
Loading system	Side load rack
Loading capacity	280 mm
Loading side	Right/Left
Applications	
Headstock type	Fixed/sliding
Remnant length	Min. 90 / Max. 400
Front rest	Pneumatic, V-shaped elements
Bar selection	Manual
3S Synchronization	Standard
Z axis retraction	390 mm
Remote control	Color touch screen
Changeover	
Partial changeover	2 min (in the same guiding elements)
Total changeover	10 min (for all guiding elements)
Driving system	
Motor	Servo
Drive	Chain
Guiding	Hydrostatic/bearings
Oil	35L ISO VG 100
Weight	3 m: 850 kg / 4 m: 1050 kg
Options	
2-positions Z-axis retraction	Adjustable (max. 310 mm)

## FLOOR PLAN (MM)

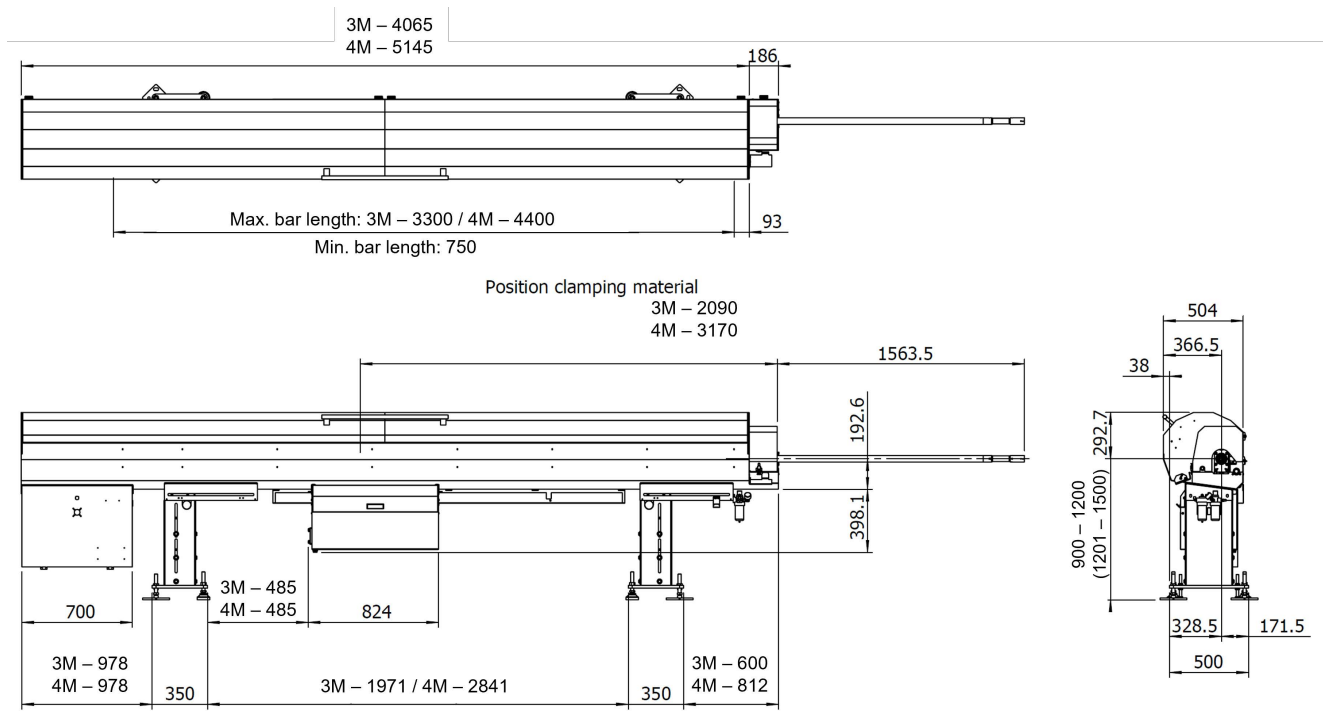

LNS Europe  
Route de Frinvillier  
2534 Orvin  
Switzerland

+41 32 358 02 00  
LNS@LNS-europe.com  
www.LNS-europe.com